

Fischer lifting clamp for sandwich panels

Lifting, turning and laying sandwich panels requires a suitable lifting clamp. The Fischer lifting clamp presented here was developed especially for these special requirements. The gripping area is sufficiently dimensioned and the contact pressure is such that the pressure exerted by the clamp does not damage the sandwich panels.



Picture 1

Product description

The lifting clamp represents a stable steel construction that can safely lift the load (panels, sheets) with a form-fitting clamping jaw.

With the help of the dead weight of the load, the required contact pressure is generated via a lever mechanism with a chain hanger.

The clamping force of the jaws depends on the dead weight of the load. Different load thicknesses can be adjusted with a hole grid of the lifting clamp.

A thickness deviation (<10 mm) of the load is absorbed by the lever of the lever clamp. A tension spring provides the necessary holding force for the lifting clamp to be held without load.

Features and advantages of the lifting clamp for sandwich panels:

- Suitable for form-fitting lifting, turning and laying of sandwich panels
- Coated gripping jaws leave no marks or damage
- Adjustability of the gripping area
- Easy change of gripper jaws for different profiles
- Maximum permissible inclined pull 30°

Please note when using this lifting clamp:

- Form-fit arrangement of the clamping jaws is absolutely necessary for safe use of the clamp!
- For panel lengths > 5m, the use of two clamps on a crossbar or a correspondingly long sling is recommended.

Safety

The lifting clamp is intended for lifting, lowering and moving **one** sandwich panel with a polyurethane rigid foam core (manufactured according to DIN EN 14509:2013-12) - when operated by one person. Any use beyond this is considered improper use.

Use in an explosive environment is not permitted.

Any

- modifications or extensions
- use of non-original spare parts
- repairs carried out by companies or persons not authorised by the manufacturer

not expressly approved in writing by the manufacturer may invalidate the warranty.



Picture 2



Picture 3



Picture 4

Picture 1: Lifting clamp 120 with special gripping jaw

Picture 2: Lifting clamp 120

Picture 3: Lifting clamp 240 with special gripping jaw

Picture 4: Lifting clamp 240

Special gripping jaw for roof panels

Technical data CGSMVS

	Typ 120	Typ 240
Dimensions (WxDxH in mm) <i>Smallest span set</i>	250 x 255 x 360	360 x 255 x 360
Gripping width (mm)	30 - 120 *	120 - 240
Load capacity (kg)	250	250
Weight (approx. kg)	11	15,4

Order numbers:

With standard jaw	FI 84.061	FI 84.062
With special jaw	FI 84.064	FI 84.065
Only special jaw for retrofitting	FI 84.063	

* Attention: From panel type FischerTHERM DL 160 onwards, type 240 is required (130 mm clamping range)

Dangers due to the lifting clamp

The operator must ensure that the user is adequately informed of possible dangers and follows these instructions. Surfaces must be free of dust and lubricants. Further instructions can be found in the operating instructions.

Assemblies and functional elements

- F Handle (back)
- G Handle and lever for opening the jaws
- 14 Closing spring Clamping jaws
- 15 Chain hanger
- 16 Ball lock pin for adjustment of distance between clamping jaws
- 17 Oval suspension ring
- 33 Ball lock pin for change fixed clamping jaw
- 38 Clamping jaw movable
- 39 Clamp jaw fixed

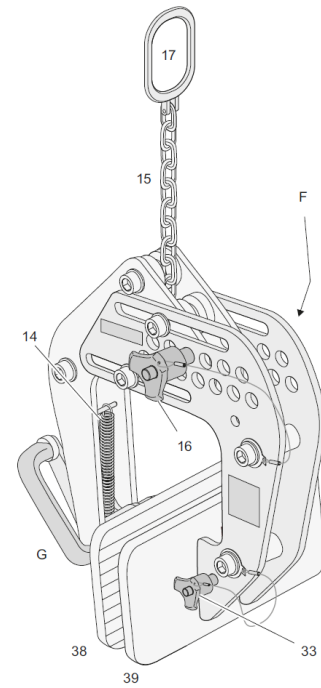

Picture 5: Lifting clamp designations

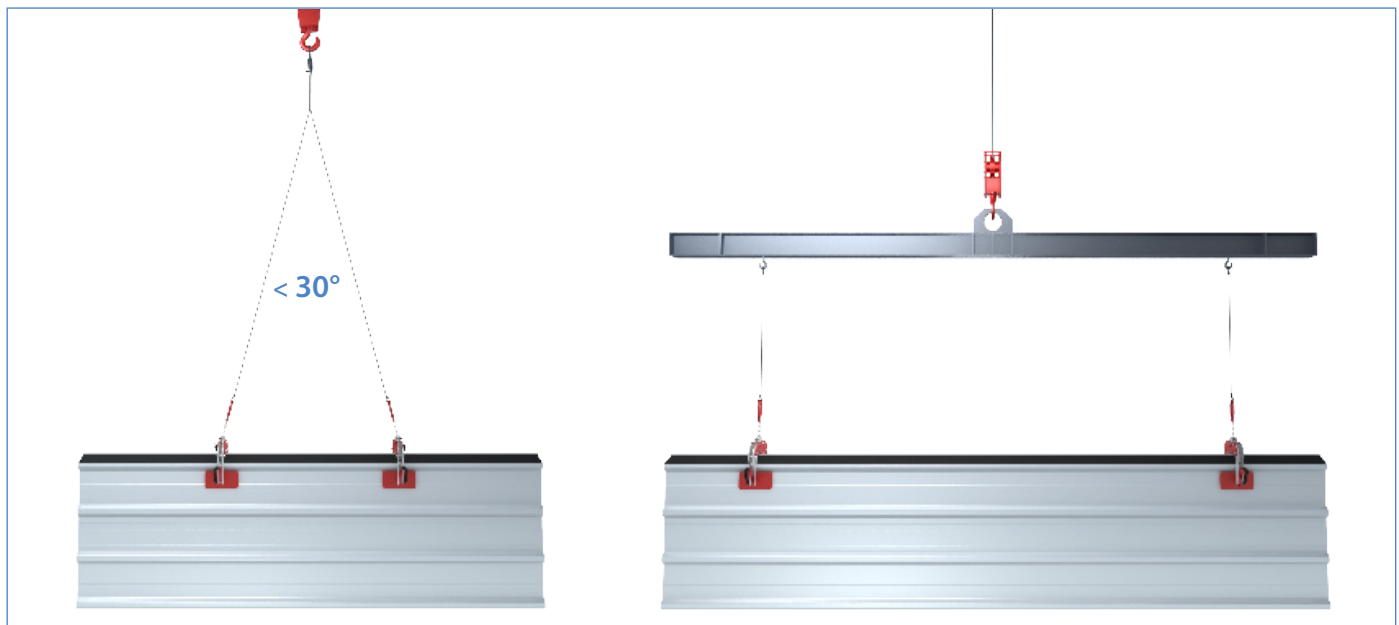

Picture 6: Maximum permissible inclined pull 30° and use of crossbeams

Fischer Profil GmbH
 Waldstraße 67
 57250 Netphen-Deuz
 T: +49 (0) 2737 508 0
 info@fischerprofil.de

English 07/2021

www.fischerprofil.de

Every care has been taken to ensure that the contents of this publication are accurate. However, Tata Steel nor its subsidiaries accept any responsibility or liability whatsoever for any errors or information deemed to be misleading.

It is the responsibility of the customer to check the suitability of products supplied or manufactured by Tata Steel or its subsidiaries before using them.

Copyright 2021
 Tata Steel Europe Limited